

**ARTLINE**®  
LIGHT IS MORE

**sapa:**  
**buildingsystem**  
ARCHITECTURAL ALUMINIUM SOLUTIONS



## Design

Elegantly bringing the outside inside, the Artline window is art with a purpose - quality, lightness and comfort. Its design implies a conscious effort to create an art object that is both functionally and aesthetically pleasing. Creative both in its design and in its effect on the building and the user, Artline is contemporary architecture.



BFTLINE® LIGHT IS MORE







# Minimal

The impression of extreme simplicity and lightness of Artline is a result of the special attention given to the combined action between glass, frameless windows, elegant lighting and careful architectural consideration of spaces where LIGHT IS MORE. Artline's sophisticated minimalist design creates a light and fluid appearance, even for large fix and openable windows.



## Functional

The range of functions that Artline is able to perform is extensive, giving it a high level of practicality. Floor to ceiling glass walls can easily be opened and closed to let the outside come in. Each vent can carry up to 450 kg, allowing both large and heavy glazed infills. Artline windows can reach up to 3,5 metres in height. The window's impressive sizes coupled with a minimal visible frame width allow building interiors to be flooded with light.





BFTLINE LIGHT IS MORE





# Technology

Artline's state of the art aluminium window technology includes optimal thermal and acoustic insulation, high weather resistance and security solutions. The high level of technology used within Artline frames makes it top performing:

- Security
- Durability
- Transparency (98%)
- Insulation:  $U_w = 0,85 \text{ W/m}^2\text{K}$  \*
- Watertightness (EN12207) E750
- Airtightness (EN12208) class 4
- Windresistance (EN12210) C3

\* with  $U_g = 0,7 \text{ W/m}^2\text{K}$ , element size 4000x2600 mm



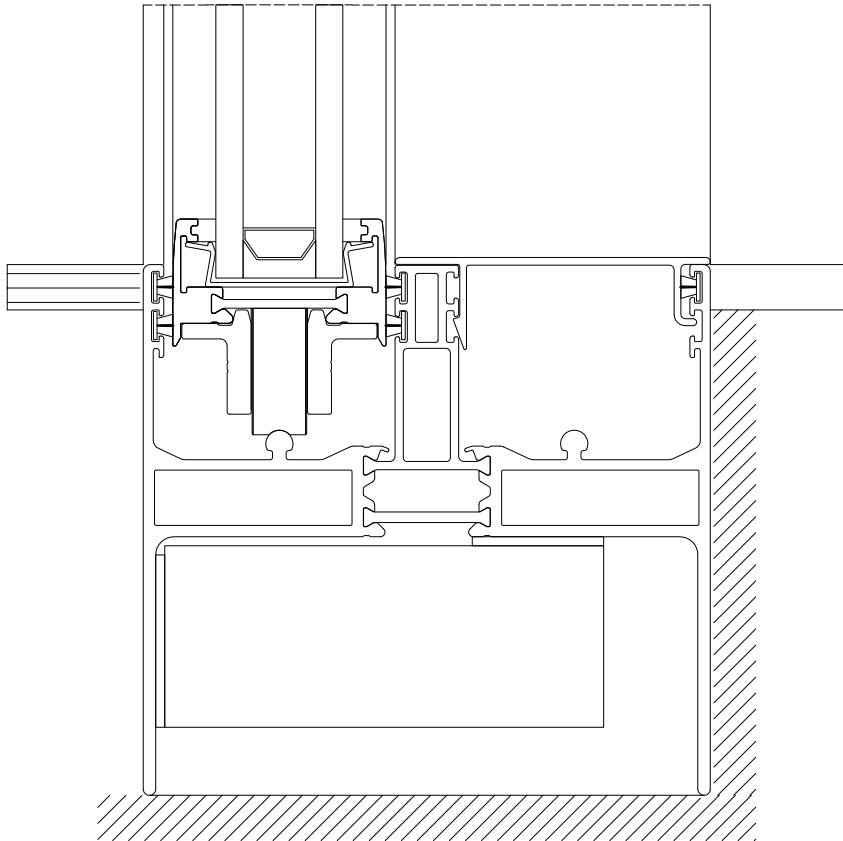

# Artline

High performance thermally insulated sliding door system with a slim sightline near the meeting stile (26 or 38 mm).

- Vent weight up to 320 kg
- 3 meters high without reinforcement
- Quadruple synthetic or stainless-steel wheels, dustproof ball bearing
- Building depth frame: 125 mm
- Vent depth: 47 mm
- Max. glazing vent: 42 mm
- Minimalistic design
- Complies with **CE** marking

Type of frame	Single insulator	Triple insulator
$U_{frame,min.}$	2,70	1,89
$U_w (U_g = 0,7 / \Psi = 0,051)$	1,18	1,09
$U_w (U_g = 0,5 / \Psi = 0,039)$	0,98	0,89

$U_w$  value based on test element of 3000 x 2800 mm

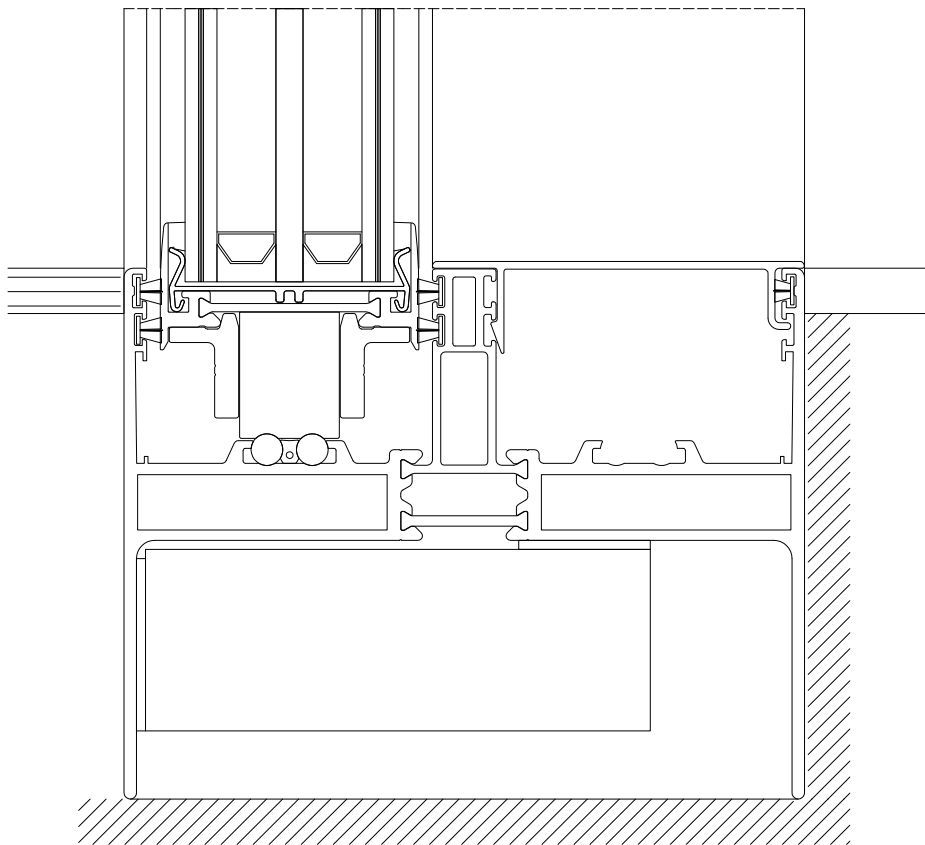

# Artline XL

High performance thermally insulated sliding door system with a slim sightline near the meeting stile (38 mm).

- Vent weight up to 450 kg
- 3,5 meters high without reinforcement
- Quadruple synthetic or stainless-steel wheels on a double rail, dustproof ball bearing
- Building depth frame: 150 mm
- Vent depth: 57 mm
- Max. glazing vent: 52 mm
- Minimalistic design
- Complies with **CE** marking
- Burglary resistance class RC2

Type of frame	Single insulator	Triple insulator
$U_{\text{frame,min.}}$	2,02	/
$U_w (U_g = 0,7 / \Psi = 0,051)$	1,09	/
$U_w (U_g = 0,5 / \Psi = 0,039)$	0,91	/

$U_w$  value based on test element of 3000 x 2800 mm

**sapa:**

**buildingsystem**

ARCHITECTURAL ALUMINIUM SOLUTIONS

[www.artlinebysapa.com](http://www.artlinebysapa.com)

Austria Belgium Czech Republic Denmark France Finland India Italy Lithuania Netherlands Norway Poland Portugal Slovakia Spain Sweden Turkey U.A.E. UK